



Measures Technology Values Innovation



VRLA Rechargeable Battery

SHR10-12

FEATURES

- Maintenance free(no water topping-up required)
- No free acid(Non-spillable battery)
- Can be used in any orientation(excluding used inverted)
- The battery is designed for high rate usage
- Its design life is up to 5 years in floating application
- Absorbent Glass Mat technology for efficient gas recombination
- The power density at 2 min~15min discharging rate is 50% higher than BP series

APPLICATION

- UPS
- Laboratory Equipment
- Fishing Lights
- Fishing Lights Booster
- Power Packs
- Toy-Cars

SPECIFICATIONS

Nominal Voltage	12V
Nominal Capacity	10 Hour Rate (8.8 Ah, 1.75V/Cell) 15 Min Rate (40W, 1.60V/Cell)
Approx. Weight	2700g(5.95lbs.)
Terminals	T2 (Faston Tab 250) , T1 and B0 are optional
Max. Discharge Current	130 A (5 sec.)
Max. Charge Current	2.7 A
Operating Temperature Range	Charge 0°C~40°C(32°F~104°F) Discharge -20°C~50°C(-4°F~122°F) Storage -20°C~40°C(-4°F~104°F)
Self Discharge	< 3% per month (25°C)
Internal Resistance	≤12mΩ (Fully Charged)



CONTAINER MATERIAL

- Standard: ABS(UL 94-HB)
Model Name: SHR10-12
- Optional: Flame Retardant ABS(UL 94-V0)
Model Name: SHR10-12FR

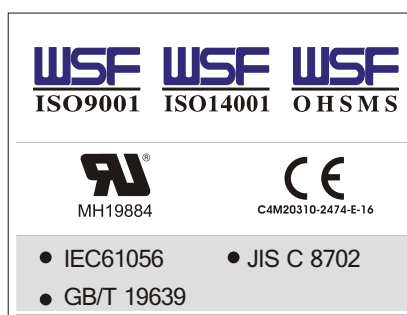

OUTER DIMENSIONS mm(inch)	Length (L)	Width (W)	Container Height (H)	Total Height (TH)
		151±1.5(5.94±0.06)	65±1.5(2.56±0.06)	94±1.5(3.70±0.06)

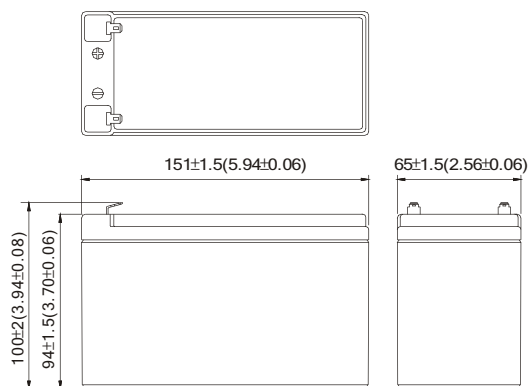

TERMINAL TYPE

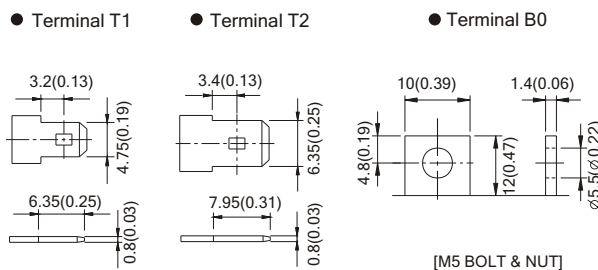

SHR10-12 (SHR10-12FR) discharge characteristics (25°C/77°F)

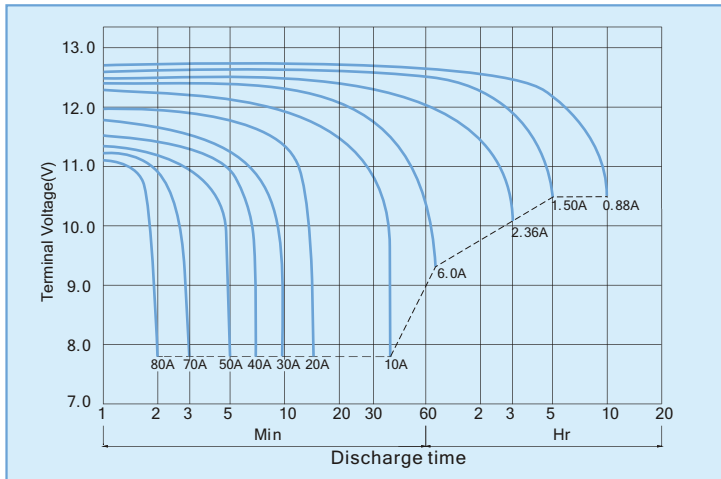

Battery Charging Characteristics

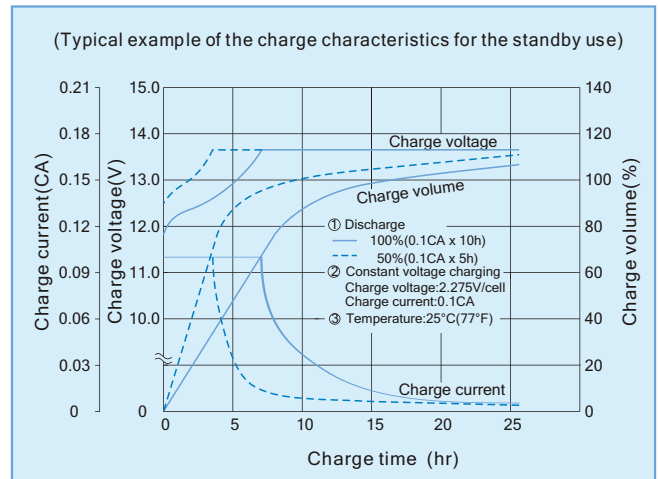

Charging Procedure

Application	Charging method	Charging Voltage at 25°C (V/cell)	Temperature compensation coefficient of charging voltage (mV/°C/cell)	Max. charging current (A)	Charging time 0.1CA, 25°C (h)		Temp (°C)
					100% discharge	50% discharge	
For standby power Source	Constant voltage & Constant current charging (with current restriction)	2.25~2.30	-3	2.7	24	20	0~40 (32~104°F)
For cycle service		2.40~2.50	-4	2.7	16	10	

Effect Of Temperature On Long Term Float Life

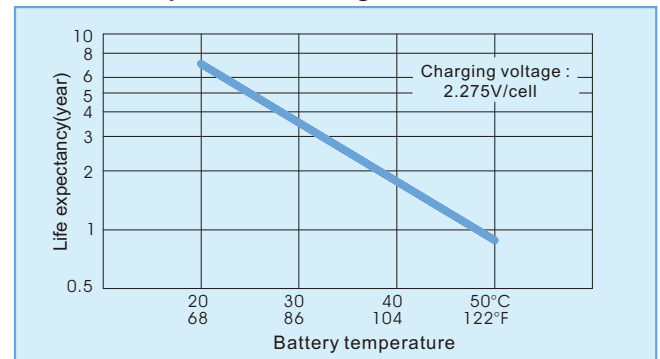

Constant power discharge characteristics at 25 °C/77 °F Unit: W

F.V. (V/cell) \ Discharge Time	2 Min	3 Min	5 Min	10 Min	15 Min	20 Min	30 Min	40 Min	50 Min	60 Min	120 Min
1.80V	760	609	451	294	239	186	136.6	99.6	86.8	77.9	42.0
1.75V	815	655	483	312	245	190	139.6	102.5	89.0	79.0	42.7
1.70V	857	686	503	318	248	194	141.0	103.7	89.8	79.5	42.9
1.67V	876	707	521	326	251	196	142.3	104.7	90.5	79.7	43.5
1.60V	892	725	540	332	252	197	143.5	106.0	91.1	80.0	43.5
1.50V	902	732	545	333	253	198	143.8	106.3	91.3	80.1	43.6

Constant current discharge characteristics at 25 °C/77 °F Unit: A

F.V. (V/cell) \ Discharge Time	2 Min	3 Min	5 Min	10 Min	15 Min	20 Min	30 Min	40 Min	50 Min	60 Min	120 Min
1.80V	70.0	55.8	40.4	25.7	20.7	15.88	11.58	8.46	7.29	6.54	3.50
1.75V	75.2	60.3	43.8	27.4	21.1	16.34	11.90	8.70	7.50	6.65	3.56
1.70V	79.3	63.4	45.4	28.0	21.4	16.59	12.01	8.93	7.56	6.68	3.57
1.67V	81.1	65.2	47.2	28.7	21.7	16.77	12.14	8.81	7.63	6.71	3.61
1.60V	82.8	67.0	49.0	29.3	21.9	16.95	12.25	9.04	7.70	6.74	3.64
1.50V	83.8	67.7	49.4	29.5	22.0	16.99	12.28	9.06	7.72	6.75	3.64

All data and artworks shall be changed without prior notice, BB reserves the right to explain and update the information contained herein.

Trial B/0 REV. Aug. 2013

USA:
B&B BATTERY(USA) INC.
6415 RANDOLPH ST.COMMERCE, CA,90040 U.S.A.
TEL:1-323-278-1900.1-800-278-8599
FAX:1-323-278-1268
E-Mail:sales@bb-battery.com

CHINA FACTORY:
B.B. BATTERY CO., LTD.
CHENG DONG TRIAL AREA,HUANG GANG,
RAOPING, GUANG DONG,CHINA,515700
TEL:86-768-7601001-2
FAX:86-768-7601469
E-Mail:maggy@bb-battery.com

EUROPE:
B&B BATTERY(EUROPE) B.V.
SUITE 8, HAAKSBERGWEG 33, 1101
BP AMSTERDAM, THE NETHERLANDS
TEL: 31-30-3200190
MOBILE: 852-9128-2711
E-Mail: dliu@bb-battery.com

HONG KONG:
B&B BATTERY(Hong Kong) Co.
TEL:852-2311-4918
FAX:852-2739-1182
E-Mail:bbhk@hkstar.com

JAPAN:
B&B BATTERY(JAPAN) CO., LTD.
1375-11 NARAHARA-MACHI,HACHIOJI,
TOKYO 193-0803,JAPAN.
TEL:81-426-25-6375
FAX:81-426-25-6375
E-Mail:miyata@bb-battery.com

TAIWAN:
B.B. BATTERY(TAIWAN) CO., LTD.
TEL:886-6-502-5150
FAX:886-6-589-8087
E-Mail:kevinlin@bb-battery.com